

PLAN CADASTRAL

UAT: Pastraveni, judetul: NEAMT, Sect. cad. 34, plansa 2

Scara 1:1000

Sistem de proiectie: stereografic 1970

Spre Publicare

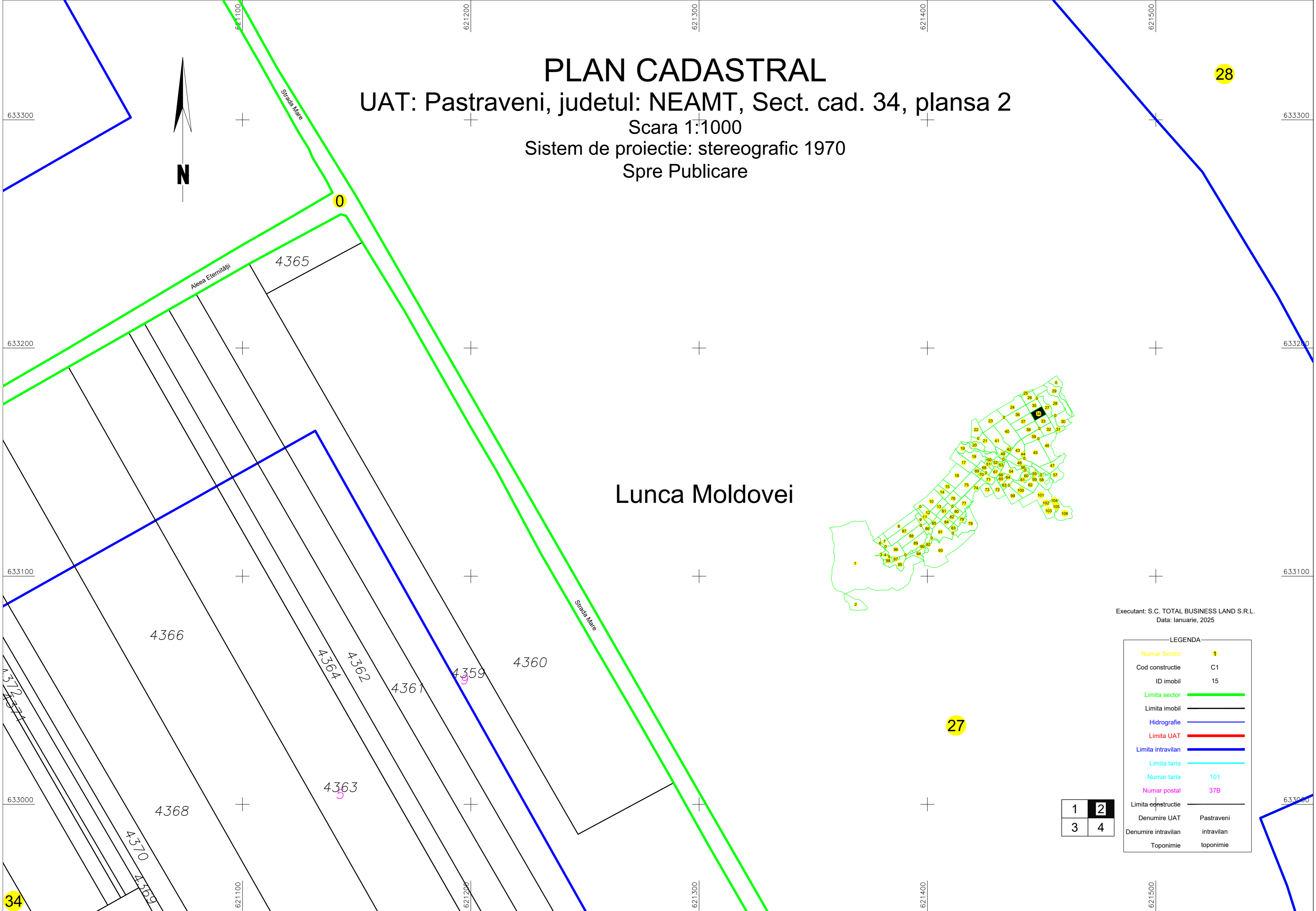

Lunca Moldovei

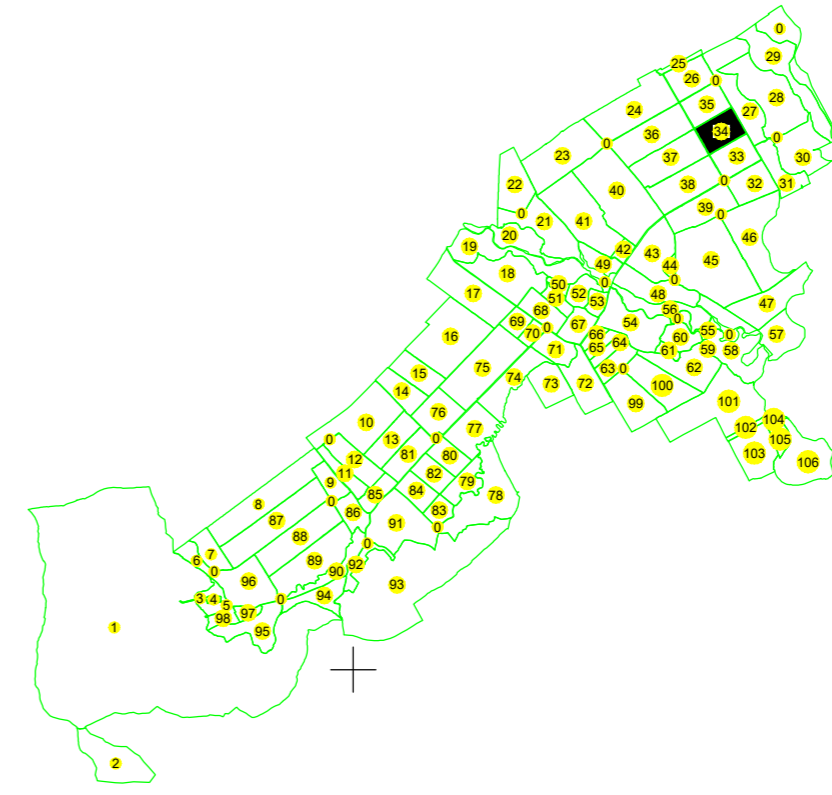

Executant: S.C. TOTAL BUSINESS LAND S.R.L.
Data: Ianuarie, 2025

| LEGENDA | |
|---------------------|------------|
| Numar Sector | 1 |
| Cod constructie | C1 |
| ID imobil | 15 |
| Limita sector | |
| Limita imobil | |
| Hidrografie | |
| Limita UAT | |
| Limita intravilan | |
| Limita tarla | |
| Numar tarla | 101 |
| Numar postal | 37B |
| Limita constructie | |
| Denumire UAT | Pastraveni |
| Denumire intravilan | intravilan |
| Toponimie | toponimie |

| | |
|---|----------|
| 1 | 2 |
| 3 | 4 |

34

28

27