

**DATE DESPRE IMOBILUL NR. 6071**

Oficiul de Cadastru și Publicitate Imobiliară NEAMT
Biroul de Cadastru și Publicitate Imobiliară Targu-Neamt

A. Partea I. Descrierea imobilului

TEREN Extravilan

Adresa: Jud. Neamt

Nr. Crt	Nr cadastral Nr. topografic	Suprafața* (mp)	Observații / Referințe
A1		Din acte: 2.090.000 Masurata: 208.198	Sector cadastral:26 Teren neimprejmuit;

B. Partea II. Proprietari și acte

Inscrieri privitoare la dreptul de proprietate și alte drepturi reale	Referințe
/	
Act Normativ nr. HG 1356, din 27/12/2001 emis de GUVERNUL ROMÂNIEI (HCL 8/27.01.2016, ELIBERAT DE CL URECHENI; ANEXA NR.1,ADEVERINȚA NR.514 DIN 30.01.2024 EMISĂ DE PRIMĂRIA COMUNEI URECHENI);	
B1	Inscrierea provizorie, drept de PROPRIETATEPOZIȚIA DIN INVENTAR 34, COD 4.1, dobandit prin Lege, cota actuala 1/1
1) COMUNA URECHENI, CIF:2614260, DOMENIUL PUBLIC	

C. Partea III. SARCINI .

Inscrieri privind dezmembramintele dreptului de proprietate, drepturi reale de garanție și sarcini	Referințe
NU SUNT	

Anexa Nr. 1 La Partea I

Teren

Nr cadastral	Suprafața (mp)*	Observații / Referințe
	Din acte: 2.090.000 Masurata: 208.198	

* Suprafața este determinată în plan de proiecție Stereo 70.

DETALII LINIARE IMOBIL

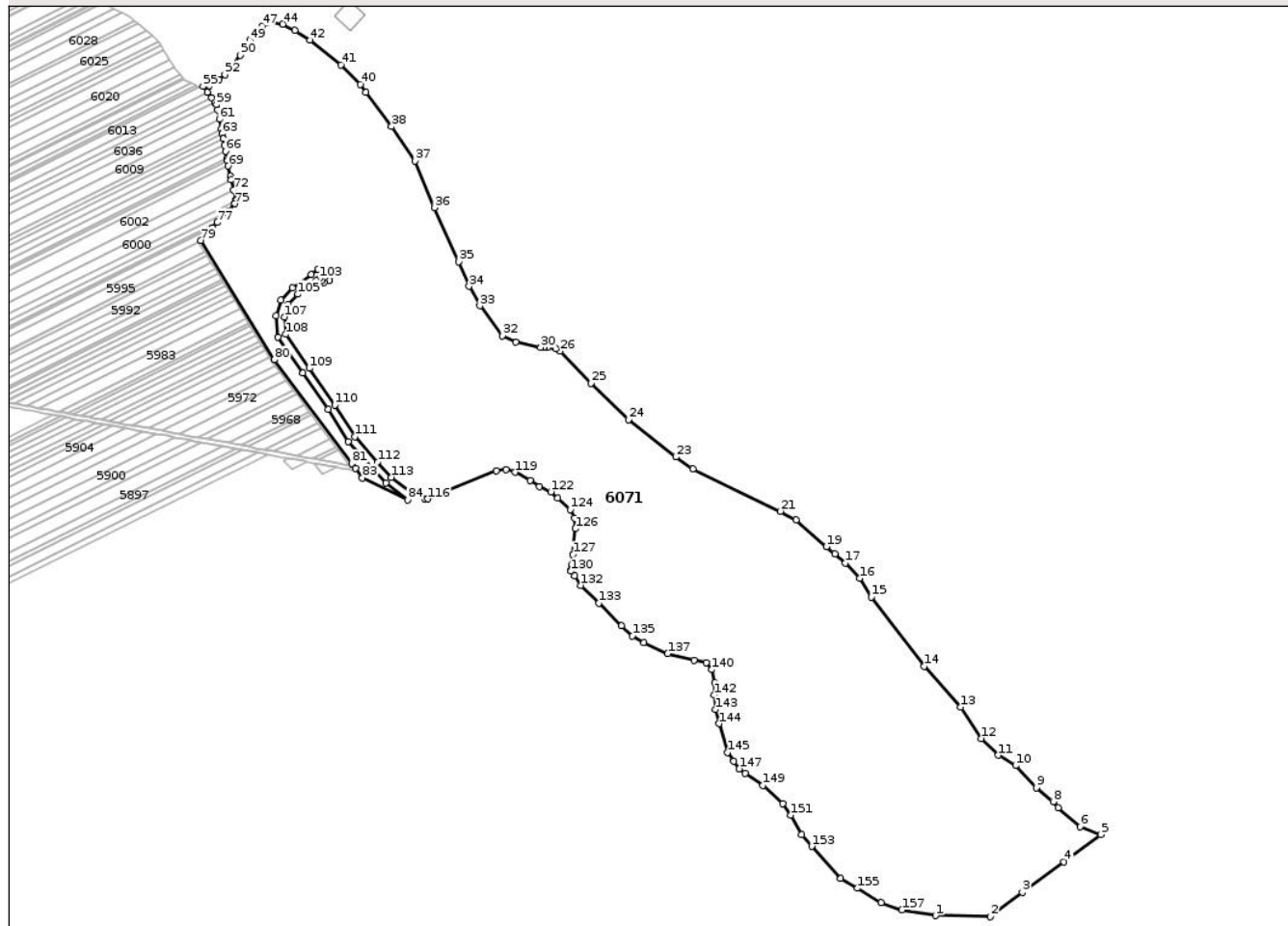

Date referitoare la teren

Crt	Categorie folosință	Intra vilan	Suprafața (mp)	Tarla	Parcelă	Nr. topo	Observații / Referințe
1	neproductiv	NU	208.198	16	210,217	-	

Lungime Segmente

1) Valorile lungimilor segmentelor sunt obținute din proiecție în plan.

Punct început	X / Y	Punct sfârșit	X / Y	Lungime segment	Punct început	X / Y	Punct sfârșit	X / Y	Lungime segment	Punct început	X / Y	Punct sfârșit	X / Y	Lungime segment
1	620.804,298 634.687,989	2	620.859,375 634.686,918	55.087	2	620.859,375 634.686,918	3	620.891,319 634.711,308	40.191	3	620.891,319 634.711,308	4	620.933,06 634.742,119	51.881
4	620.933,06 634.742,119	5	620.970,049 634.769,423	45.975	5	620.970,049 634.769,423	6	620.949,376 634.777,217	22.094	6	620.949,376 634.777,217	7	620.927,292 634.796,406	29.256
7	620.927,292 634.796,406	8	620.922,372 634.802,337	7.706	8	620.922,372 634.802,337	9	620.905,729 634.816,497	21.852	9	620.905,729 634.816,497	10	620.884,778 634.838,714	30.538
10	620.884,778 634.838,714	11	620.867,238 634.849,04	20.354	11	620.867,238 634.849,04	12	620.850,349 634.865,954	23.902	12	620.850,349 634.865,954	13	620.829,554 634.897,452	37.743

Punct început	X / Y	Punct sfârșit	X / Y	Lungime segment	Punct început	X / Y	Punct sfârșit	X / Y	Lungime segment	Punct început	X / Y	Punct sfârșit	X / Y	Lungime segment
13	620.829,554 634.897,452	14	620.792,951 634.938,416	54.935	14	620.792,951 634.938,416	15	620.739,781 635.007,696	87.331	15	620.739,781 635.007,696	16	620.728,12 635.026,638	22.244
16	620.728,12 635.026,638	17	620.713,763 635.042,12	21.114	17	620.713,763 635.042,12	18	620.703,095 635.051,129	13.963	18	620.703,095 635.051,129	19	620.694,547 635.058,476	11.272
19	620.694,547 635.058,476	20	620.664,152 635.085,299	40.538	20	620.664,152 635.085,299	21	620.648,319 635.093,971	18.052	21	620.648,319 635.093,971	22	620.560,336 635.136,289	97.631
22	620.560,336 635.136,289	23	620.543,249 635.148,357	20.919	23	620.543,249 635.148,357	24	620.495,984 635.185,878	60.347	24	620.495,984 635.185,878	25	620.458,429 635.222,32	52.33
25	620.458,429 635.222,32	26	620.427,369 635.254,738	44.896	26	620.427,369 635.254,738	27	620.422,98 635.257,124	4.996	27	620.422,98 635.257,124	28	620.414,379 635.258,609	8.728
28	620.414,379 635.258,609	29	620.410,372 635.258,392	4.013	29	620.410,372 635.258,392	30	620.407,578 635.258,265	2.797	30	620.407,578 635.258,265	31	620.382,879 635.263,657	25.281
31	620.382,879 635.263,657	32	620.369,017 635.270,29	15.367	32	620.369,017 635.270,29	33	620.346,58 635.300,273	37.449	33	620.346,58 635.300,273	34	620.335,697 635.319,805	22.359
34	620.335,697 635.319,805	35	620.325,085 635.344,605	26.975	35	620.325,085 635.344,605	36	620.300,894 635.398,885	59.427	36	620.300,894 635.398,885	37	620.281,643 635.445,721	50.638
37	620.281,643 635.445,721	38	620.257,856 635.480,239	41.92	38	620.257,856 635.480,239	39	620.231,868 635.514,321	42.86	39	620.231,868 635.514,321	40	620.226,292 635.522,349	9.774
40	620.226,292 635.522,349	41	620.206,96 635.542,264	27.755	41	620.206,96 635.542,264	42	620.175,871 635.567,042	39.755	42	620.175,871 635.567,042	43	620.160,801 635.576,787	17.946
43	620.160,801 635.576,787	44	620.148,779 635.583,122	13.589	44	620.148,779 635.583,122	45	620.136,736 635.585,388	12.254	45	620.136,736 635.585,388	46	620.132,188 635.583,78	4.824
46	620.132,188 635.583,78	47	620.127,603 635.581,105	5.308	47	620.127,603 635.581,105	48	620.121,872 635.575,753	7.841	48	620.121,872 635.575,753	49	620.115,536 635.566,751	11.008
49	620.115,536 635.566,751	50	620.105,833 635.551,875	17.761	50	620.105,833 635.551,875	51	620.094,809 635.536,455	18.955	51	620.094,809 635.536,455	52	620.090,439 635.532,392	5.967
52	620.090,439 635.532,392	53	620.084,376 635.527,219	7.97	53	620.084,376 635.527,219	54	620.074,528 635.520,958	11.67	54	620.074,528 635.520,958	55	620.068,368 635.520,389	6.186
55	620.068,368 635.520,389	56	620.072,687 635.514,671	7.166	56	620.072,687 635.514,671	57	620.077,059 635.508,883	7.253	57	620.077,059 635.508,883	58	620.080,523 635.504,297	5.747
58	620.080,523 635.504,297	59	620.082,011 635.502,326	2.47	59	620.082,011 635.502,326	60	620.083,039 635.496,997	5.427	60	620.083,039 635.496,997	61	620.084,862 635.487,543	9.629
61	620.084,862 635.487,543	62	620.086,747 635.477,772	9.951	62	620.086,747 635.477,772	63	620.087,693 635.472,868	4.994	63	620.087,693 635.472,868	64	620.088,641 635.467,953	5.006
64	620.088,641 635.467,953	65	620.089,859 635.461,636	6.434	65	620.089,859 635.461,636	66	620.091,021 635.455,613	6.134	66	620.091,021 635.455,613	67	620.092,482 635.448,035	7.718
67	620.092,482 635.448,035	68	620.092,855 635.446,103	1.968	68	620.092,855 635.446,103	69	620.093,922 635.440,57	5.635	69	620.093,922 635.440,57	70	620.095,858 635.430,531	10.224
70	620.095,858 635.430,531	71	620.096,742 635.426,746	3.887	71	620.096,742 635.426,746	72	620.099,125 635.416,542	10.478	72	620.099,125 635.416,542	73	620.101,5 635.406,375	10.441
73	620.101,5 635.406,375	74	620.101,398 635.406,049	0.341	74	620.101,398 635.406,049	75	620.100,332 635.402,656	3.557	75	620.100,332 635.402,656	76	620.093,268 635.395,009	10.41
76	620.093,268 635.395,009	77	620.082,951 635.383,84	15.205	77	620.082,951 635.383,84	78	620.077,988 635.378,467	7.315	78	620.077,988 635.378,467	79	620.066,373 635.365,893	17.117
79	620.066,373 635.365,893	80	620.140,21 635.246,086	140.732	80	620.140,21 635.246,086	81	620.217,851 635.141,884	129.947	81	620.217,851 635.141,884	82	620.221,361 635.137,174	5.874
82	620.221,361 635.137,174	83	620.228,534 635.127,548	12.005	83	620.228,534 635.127,548	84	620.273,888 635.105,566	50.401	84	620.273,888 635.105,566	85	620.252,196 635.122,204	27.338
85	620.252,196 635.122,204	86	620.237,932 635.137,961	21.254	86	620.237,932 635.137,961	87	620.214,475 635.163,871	34.951	87	620.214,475 635.163,871	88	620.194,132 635.196,276	38.261
88	620.194,132 635.196,276	89	620.168,725 635.232,892	44.567	89	620.168,725 635.232,892	90	620.143,859 635.268,727	43.617	90	620.143,859 635.268,727	91	620.142,018 635.289,931	21.285
91	620.142,018 635.289,931	92	620.146,73 635.305,875	16.625	92	620.146,73 635.305,875	93	620.158,503 635.317,877	16.812	93	620.158,503 635.317,877	94	620.177,194 635.331,674	23.232
94	620.177,194 635.331,674	95	620.184,157 635.337,104	8.829	95	620.184,157 635.337,104	96	620.188,737 635.337,031	4.581	96	620.188,737 635.337,031	97	620.192,445 635.336,086	3.826
97	620.192,445 635.336,086	98	620.194,626 635.334,633	2.621	98	620.194,626 635.334,633	99	620.195,789 635.330,637	4.162	99	620.195,789 635.330,637	100	620.195,717 635.325,26	5.377
100	620.195,717 635.325,26	101	620.190,187 635.323,793	5.721	101	620.190,187 635.323,793	102	620.187,646 635.325,551	3.089	102	620.187,646 635.325,551	103	620.184,811 635.327,512	3.448
103	620.184,811 635.327,512	104	620.182,03 635.325,301	3.553	104	620.182,03 635.325,301	105	620.163,767 635.311,819	22.7	105	620.163,767 635.311,819	106	620.153,837 635.301,696	14.181
106	620.153,837 635.301,696	107	620.150,119 635.289,116	13.118	107	620.150,119 635.289,116	108	620.151,645 635.271,539	17.643	108	620.151,645 635.271,539	109	620.175,297 635.237,452	41.489
109	620.175,297 635.237,452	110	620.200,809 635.200,686	44.751	110	620.200,809 635.200,686	111	620.220,877 635.168,72	37.743	111	620.220,877 635.168,72	112	620.243,863 635.143,33	34.249

Punct început	X / Y	Punct sfârșit	X / Y	Lungime segment	Punct început	X / Y	Punct sfârșit	X / Y	Lungime segment	Punct început	X / Y	Punct sfârșit	X / Y	Lungime segment
112	620.243,863 635.143,33	113	620.257,641 635.128,111	20.529	113	620.257,641 635.128,111	114	620.277,961 635.112,523	25.611	114	620.277,961 635.112,523	115	620.291,135 635.106,877	14.333
115	620.291,135 635.106,877	116	620.294,08 635.106,365	2.989	116	620.294,08 635.106,365	117	620.363,268 635.134,832	74.816	117	620.363,268 635.134,832	118	620.372,537 635.135,776	9.317
118	620.372,537 635.135,776	119	620.381,783 635.133,239	9.588	119	620.381,783 635.133,239	120	620.396,962 635.124,974	17.284	120	620.396,962 635.124,974	121	620.406,352 635.118,984	11.138
121	620.406,352 635.118,984	122	620.417,855 635.113,425	12.776	122	620.417,855 635.113,425	123	620.424,8 635.107,042	9.432	123	620.424,8 635.107,042	124	620.437,219 635.095,625	16.87
124	620.437,219 635.095,625	125	620.441,671 635.087,123	9.597	125	620.441,671 635.087,123	126	620.442,536 635.076,402	10.756	126	620.442,536 635.076,402	127	620.440,061 635.050,38	26.139
127	620.440,061 635.050,38	128	620.438,582 635.040,036	10.449	128	620.438,582 635.040,036	129	620.437,915 635.035,367	4.717	129	620.437,915 635.035,367	130	620.438,246 635.033,717	1.682
130	620.438,246 635.033,717	131	620.441,421 635.029,173	5.543	131	620.441,421 635.029,173	132	620.448,108 635.019,604	11.675	132	620.448,108 635.019,604	133	620.466,006 635.001,632	25.364
133	620.466,006 635.001,632	134	620.488,7 634.978,846	32.159	134	620.488,7 634.978,846	135	620.499,76 634.968,796	14.944	135	620.499,76 634.968,796	136	620.511,41 634.962,087	13.443
136	620.511,41 634.962,087	137	620.535,15 634.951,126	26.149	137	620.535,15 634.951,126	138	620.561,699 634.944,64	27.33	138	620.561,699 634.944,64	139	620.573,868 634.941,667	12.527
139	620.573,868 634.941,667	140	620.579,667 634.934,981	8.85	140	620.579,667 634.934,981	141	620.582,63 634.921,607	13.698	141	620.582,63 634.921,607	142	620.581,616 634.909,678	11.972
142	620.581,616 634.909,678	143	620.582,938 634.894,989	14.748	143	620.582,938 634.894,989	144	620.587,082 634.880,791	14.791	144	620.587,082 634.880,791	145	620.595,496 634.851,96	30.033
145	620.595,496 634.851,96	146	620.601,713 634.842,999	10.907	146	620.601,713 634.842,999	147	620.606,965 634.835,429	9.213	147	620.606,965 634.835,429	148	620.613,296 634.831,001	7.726
148	620.613,296 634.831,001	149	620.630,857 634.818,72	21.429	149	620.630,857 634.818,72	150	620.650,932 634.800,674	26.994	150	620.650,932 634.800,674	151	620.658,959 634.788,803	14.33
151	620.658,959 634.788,803	152	620.669,626 634.769,27	22.256	152	620.669,626 634.769,27	153	620.680,017 634.757,624	15.608	153	620.680,017 634.757,624	154	620.708,942 634.725,206	43.446
154	620.708,942 634.725,206	155	620.725,626 634.715,494	19.305	155	620.725,626 634.715,494	156	620.749,404 634.700,802	27.95	156	620.749,404 634.700,802	157	620.770,447 634.693,727	22.201
157	620.770,447 634.693,727	1	620.804,298 634.687,989	34.334										

** Lungimile segmentelor sunt determinate în planul de proiecție Stereo 70 și sunt rotunjite la 1 milimetru.

*** Distanța dintre puncte este formată din segmente cumulate ce sunt mai mici decât valoarea 1 milimetru.



DATE DESPRE IMOBILUL NR. 6073

Oficiul de Cadastru și Publicitate Imobiliară NEAMT
Biroul de Cadastru și Publicitate Imobiliară Targu-Neamt

A. Partea I. Descrierea imobilului

TEREN Extravilan

Adresa: Jud. Neamt

Nr. Crt	Nr cadastral Nr. topografic	Suprafața* (mp)	Observații / Referințe
A1		Din acte: 2.090.000 Masurata: 205.489	Sector cadastral:26 Teren neimprejmuit;

Construcții

Crt	Nr cadastral Nr. topografic	Adresa	Observații / Referințe
A1.1		Jud. Neamt	Nr. niveluri:1; S. construita la sol:441 mp; S. construita desfasurata:441 mp; CASTEL APĂ
A1.2		Jud. Neamt	Nr. niveluri:1; S. construita la sol:441 mp; S. construita desfasurata:441 mp; CASTEL APĂ
A1.3		Jud. Neamt	Nr. niveluri:1; S. construita la sol:441 mp; S. construita desfasurata:441 mp; CASTEL APĂ

B. Partea II. Proprietari și acte

Inscrieri privitoare la dreptul de proprietate și alte drepturi reale	Referințe
/	
Act Normativ nr. HG 1356, din 27/12/2001 emis de GUVERNUL ROMÂNIEI (HCL 8/27.01.2016, ELIBERAT DE CL URECHENI; ANEXA NR.1,ADEVERINȚA NR.514 DIN 30.01.2024 EMISĂ DE PRIMĂRIA COMUNEI URECHENI);	
B1	Inscrierea provizorie, drept de PROPRIETATEPOZIȚIA DIN INVENTAR 34, COD 4.1, dobandit prin Lege, cota actuala 1/1 1) COMUNA URECHENI, CIF:2614260, DOMENIUL PUBLIC
Act Administrativ nr. 9433, din 12/12/2023 emis de PRIMĂRIA COMUNEI URECHENI;	
B2	Intabulare, drept de PROPRIETATE, dobandit prin Lege, cota actuala 1/1 1) COMUNA URECHENI, CIF:2614260, DOMENIUL PUBLIC

C. Partea III. SARCINI .

Inscrieri privind dezmembramintele dreptului de proprietate, drepturi reale de garanție și sarcini	Referințe
NU SUNT	

Anexa Nr. 1 La Partea I

Teren

Nr cadastral	Suprafața (mp)*	Observații / Referințe
	Din acte: 2.090.000 Masurata: 205.489	

* Suprafața este determinată în planul de proiecție Stereo 70.

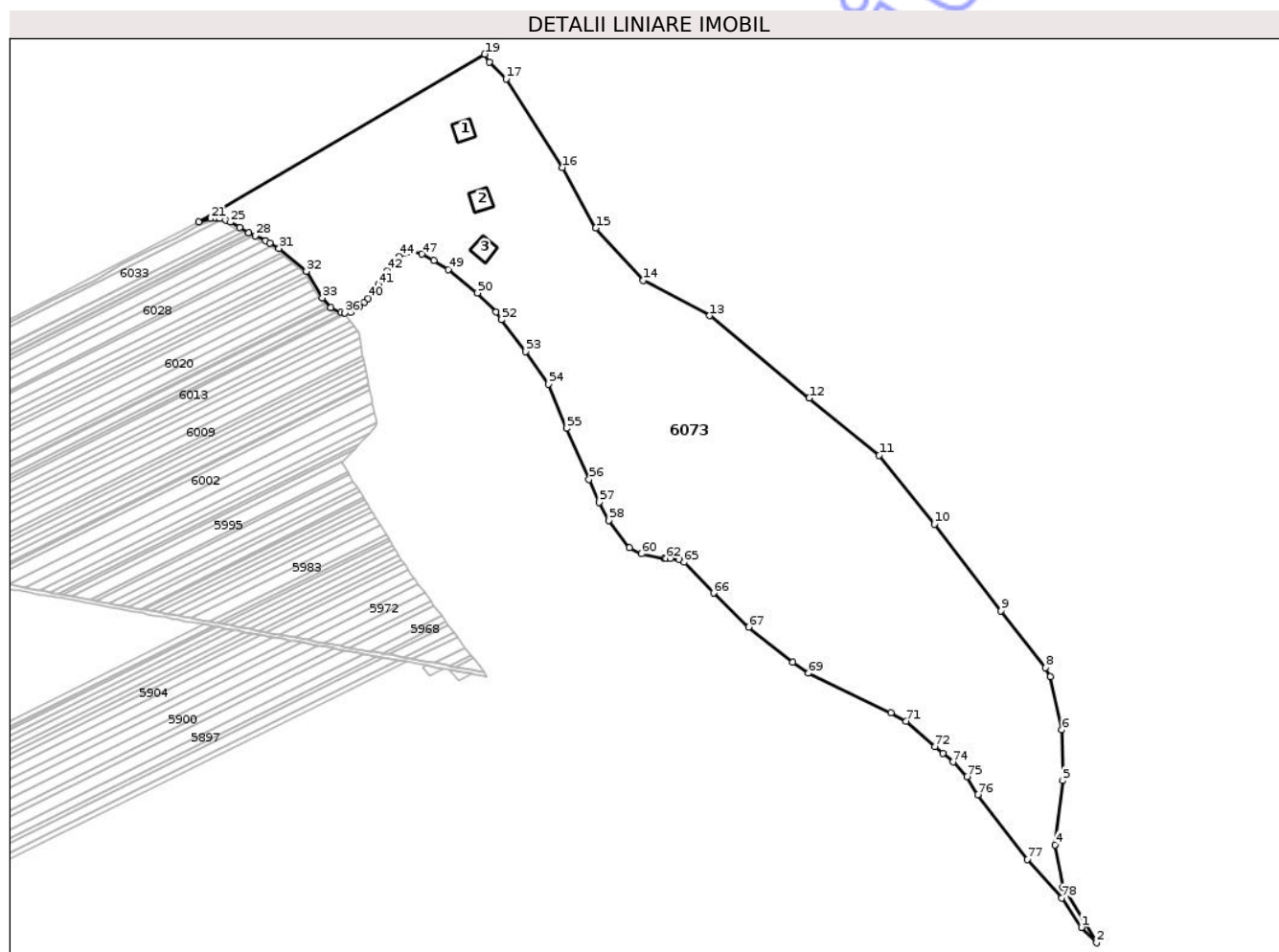

Date referitoare la teren

Crt	Categorie folosință	Intra vilan	Suprafața (mp)	Tarla	Parcelă	Nr. topo	Observații / Referințe
1	curți construcții	NU	1.323	16	217	-	
2	neproductiv	NU	204.166	16	216,217	-	

Date referitoare la construcții

Crt	Număr	Destinație construcție	Supraf. (mp)	Situație juridică	Observații / Referințe
A1.1		construcții industriale și edilitare	441	Cu acte	Nr. niveluri:1; S. construita la sol:441 mp; S. construita desfasurata:441 mp; CASTEL APĂ
A1.2		construcții industriale și edilitare	441	Cu acte	Nr. niveluri:1; S. construita la sol:441 mp; S. construita desfasurata:441 mp; CASTEL APĂ
A1.3		construcții industriale și edilitare	441	Cu acte	Nr. niveluri:1; S. construita la sol:441 mp; S. construita desfasurata:441 mp; CASTEL APĂ

Lungime Segmente

1) Valorile lungimilor segmentelor sunt obținute din proiecție în plan.

Punct început	X / Y	Punct sfârșit	X / Y	Lungime segment	Punct început	X / Y	Punct sfârșit	X / Y	Lungime segment	Punct început	X / Y	Punct sfârșit	X / Y	Lungime segment
1	620.852,777 634.867,722	2	620.869,088 634.851,432	23.05 3	2	620.869,088 634.851,432	3	620.833,386 634.910,686	69.17 9	3	620.833,386 634.910,686	4	620.824,769 634.956,02	46.14 6
4	620.824,769 634.956,02	5	620.832,764 635.024,361	68.80 7	5	620.832,764 635.024,361	6	620.831,992 635.078,334	53.97 9	6	620.831,992 635.078,334	7	620.819,751 635.135,168	58.13 7
7	620.819,751 635.135,168	8	620.814,706 635.144,776	10.85 2	8	620.814,706 635.144,776	9	620.767,144 635.205,489	77.12 5	9	620.767,144 635.205,489	10	620.696,11 635.297,907	116.5 63
10	620.696,11 635.297,907	11	620.637,246 635.371,254	94.04 7	11	620.637,246 635.371,254	12	620.562,466 635.432,434	96.61 8	12	620.562,466 635.432,434	13	620.456,518 635.520,334	137.6 64
13	620.456,518 635.520,334	14	620.385,787 635.558,054	80.16	14	620.385,787 635.558,054	15	620.334,916 635.613,849	75.50 5	15	620.334,916 635.613,849	16	620.299,143 635.678,309	73.72 1
16	620.299,143 635.678,309	17	620.239,273 635.772,754	111.8 23	17	620.239,273 635.772,754	18	620.221,726 635.790,594	25.02 3	18	620.221,726 635.790,594	19	620.216,651 635.799,235	10.02 1
19	620.216,651 635.799,235	20	619.911,586 635.620,046	353.7 99	20	619.911,586 635.620,046	21	619.924,582 635.623,979	13.57 8	21	619.924,582 635.623,979	22	619.930,268 635.624,241	5.693
22	619.930,268 635.624,241	23	619.934,056 635.624,06	3.792	23	619.934,056 635.624,06	24	619.940,312 635.622,397	6.473	24	619.940,312 635.622,397	25	619.945,419 635.620,005	5.64
25	619.945,419 635.620,005	26	619.955,48 635.614,27	11.58	26	619.955,48 635.614,27	27	619.965,03 635.608,881	10.96 6	27	619.965,03 635.608,881	28	619.972,244 635.605,458	7.985
28	619.972,244 635.605,458	29	619.982,78 635.600,412	11.68 2	29	619.982,78 635.600,412	30	619.987,569 635.597,9	5.408	30	619.987,569 635.597,9	31	619.997,294 635.592,112	11.31 7
31	619.997,294 635.592,112	32	620.026,438 635.567,659	38.04 4	32	620.026,438 635.567,659	33	620.043,428 635.539,388	32.98 4	33	620.043,428 635.539,388	34	620.052,461 635.528,691	14.0
34	620.052,461 635.528,691	35	620.063,066 635.523,789	11.68 4	35	620.063,066 635.523,789	36	620.067,21 635.523,294	4.173	36	620.067,21 635.523,294	37	620.073,53 635.523,879	6.347
37	620.073,53 635.523,879	38	620.082,589 635.529,638	10.73 4	38	620.082,589 635.529,638	39	620.088,443 635.534,633	7.695	39	620.088,443 635.534,633	40	620.092,545 635.538,446	5.6
40	620.092,545 635.538,446	41	620.103,355 635.553,568	18.58 9	41	620.103,355 635.553,568	42	620.113,052 635.568,434	17.75	42	620.113,052 635.568,434	43	620.119,598 635.577,734	11.37 2
43	620.119,598 635.577,734	44	620.125,801 635.583,527	8.488	44	620.125,801 635.583,527	45	620.130,921 635.586,514	5.928	45	620.130,921 635.586,514	46	620.136,497 635.588,486	5.915
46	620.136,497 635.588,486	47	620.149,778 635.585,987	13.51 4	47	620.149,778 635.585,987	48	620.162,318 635.579,379	14.17 4	48	620.162,318 635.579,379	49	620.177,625 635.569,481	18.22 8
49	620.177,625 635.569,481	50	620.208,979 635.544,491	40.09 5	50	620.208,979 635.544,491	51	620.228,616 635.524,262	28.19 2	51	620.228,616 635.524,262	52	620.234,294 635.516,087	9.954
52	620.234,294 635.516,087	53	620.260,285 635.482,001	42.86 5	53	620.260,285 635.482,001	54	620.284,296 635.447,159	42.31 4	54	620.284,296 635.447,159	55	620.303,652 635.400,066	50.91 5
55	620.303,652 635.400,066	56	620.327,834 635.345,806	59.40 5	56	620.327,834 635.345,806	57	620.338,394 635.321,129	26.84 1	57	620.338,394 635.321,129	58	620.349,103 635.301,909	22.00 2
58	620.349,103 635.301,909	59	620.370,977 635.272,678	36.51	59	620.370,977 635.272,678	60	620.383,859 635.266,514	14.28 1	60	620.383,859 635.266,514	61	620.407,834 635.261,28	24.53 9
61	620.407,834 635.261,28	62	620.410,223 635.261,388	2.391	62	620.410,223 635.261,388	63	620.414,555 635.261,623	4.339	63	620.414,555 635.261,623	64	620.423,978 635.259,996	9.562
64	620.423,978 635.259,996	65	620.429,212 635.257,151	5.957	65	620.429,212 635.257,151	66	620.460,557 635.224,435	45.30 8	66	620.460,557 635.224,435	67	620.497,966 635.188,135	52.12 6
67	620.497,966 635.188,135	68	620.545,048 635.150,759	60.11 4	68	620.545,048 635.150,759	69	620.561,862 635.138,884	20.58 4	69	620.561,862 635.138,884	70	620.649,691 635.096,64	97.46
70	620.649,691 635.096,64	71	620.665,886 635.087,77	18.46 6	71	620.665,886 635.087,77	72	620.696,517 635.060,738	40.85 3	72	620.696,517 635.060,738	73	620.705,041 635.053,413	11.23 9
73	620.705,041 635.053,413	74	620.715,838 635.044,294	14.13 3	74	620.715,838 635.044,294	75	620.730,52 635.028,462	21.59 2	75	620.730,52 635.028,462	76	620.742,255 635.009,4	22.38 4
76	620.742,255 635.009,4	77	620.795,263 634.940,331	87.06 5	77	620.795,263 634.940,331	78	620.831,937 634.899,288	55.04 2	78	620.831,937 634.899,288	1	620.852,777 634.867,722	37.82 4

** Lungimile segmentelor sunt determinate în plan de proiecție Stereo 70 și sunt rotunjite la 1 milimetru.

*** Distanța dintre puncte este formată din segmente cumulate ce sunt mai mici decât valoarea 1 milimetru.



DATE DESPRE IMOBILUL NR. 6072

Oficiul de Cadastru și Publicitate Imobiliară NEAMT
Biroul de Cadastru și Publicitate Imobiliară Targu-Neamt

A. Partea I. Descrierea imobilului

TEREN Extravilan

Adresa: Jud. Neamt

Nr. Crt	Nr cadastral Nr. topografic	Suprafața* (mp)	Observații / Referințe
A1		4.492	Sector cadastral:26 Teren neimprejmut;

B. Partea II. Proprietari și acte

Inscrieri privitoare la dreptul de proprietate și alte drepturi reale		Referințe
/		
Act Normativ nr. 7, din 13/03/1997 emis de PARLAMENTUL ROMÂNIEI;		
B1	Inscrierea provizorie, drept de PROPRIETATE, dobandit prin Lege, cota actuala 1/1 1) NEIDENTIFICAT NEIDENTIFICAT	A1
B2	In baza art. 13, alin. 15 din Legea nr. 7/1996, cu modificarile si completarile ulterioare, se noteaza proprietar neidentificat	A1

C. Partea III. SARCINI .

Inscrieri privind dezmembramintele dreptului de proprietate, drepturi reale de garanție și sarcini	Referințe
NU SUNT	

Anexa Nr. 1 La Partea I

Teren

Nr cadastral	Suprafața (mp)*	Observații / Referințe
	4.492	

* Suprafața este determinată în planul de proiecție Stereo 70.

DETALII LINIARE IMOBIL

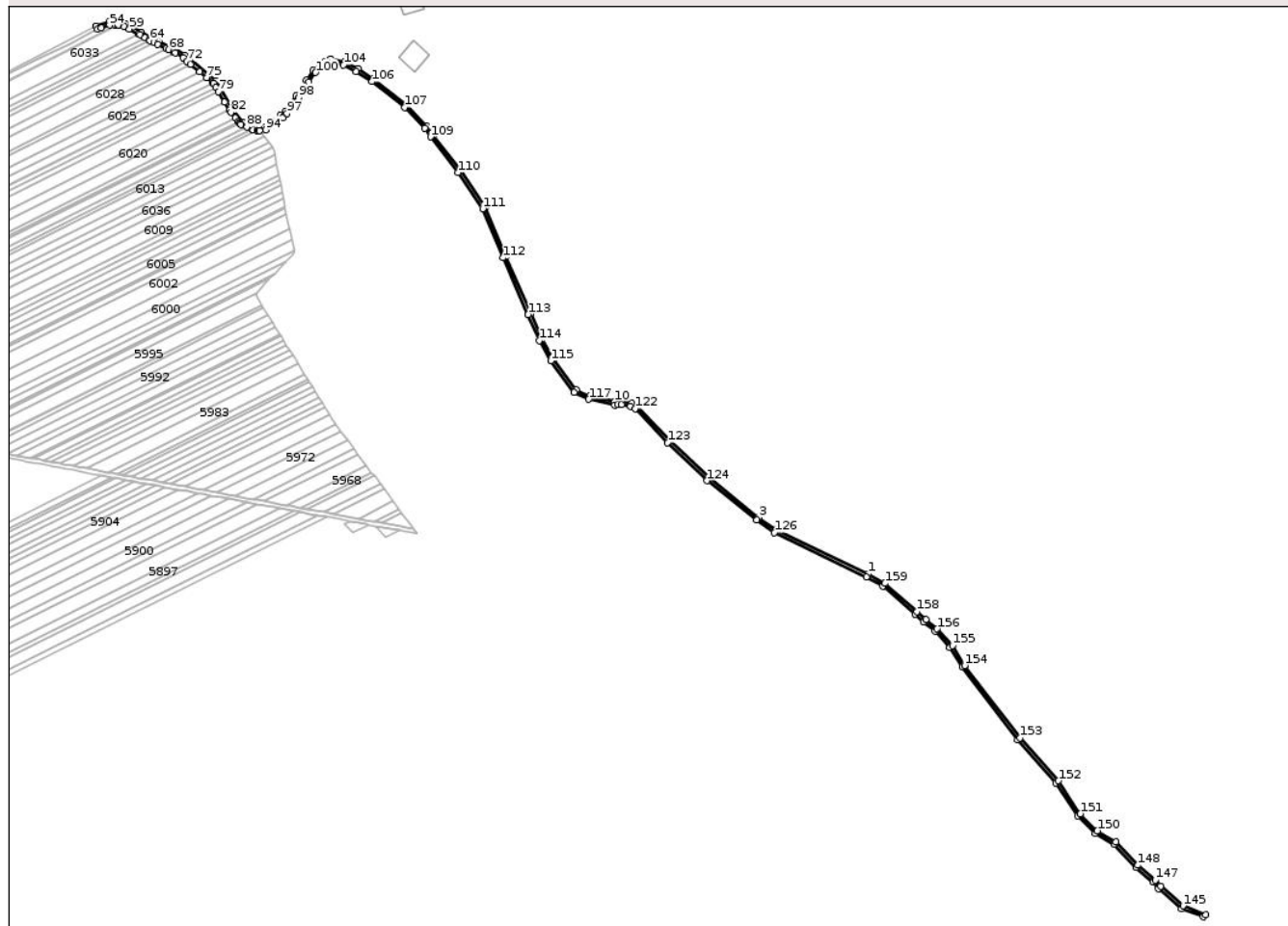

Date referitoare la teren

Crt	Categorie folosință	Intra vilan	Suprafața (mp)	Tarla	Parcelă	Nr. topo	Observații / Referințe
1	drum	NU	4.492	16	217	-	

Lungime Segmente

1) Valorile lungimilor segmentelor sunt obținute din proiecție în plan.

Punct început	X / Y	Punct sfârșit	X / Y	Lungime segment	Punct început	X / Y	Punct sfârșit	X / Y	Lungime segment	Punct început	X / Y	Punct sfârșit	X / Y	Lungime segment
1	620.649,691 635.096,64	2	620.561,862 635.138,884	97.46	2	620.561,862 635.138,884	3	620.545,048 635.150,759	20.58	3	620.545,048 635.150,759	4	620.497,966 635.188,135	60.11
4	620.497,966 635.188,135	5	620.460,557 635.224,435	52.12	5	620.460,557 635.224,435	6	620.429,212 635.257,151	45.30	6	620.429,212 635.257,151	7	620.423,978 635.259,996	5.957
7	620.423,978 635.259,996	8	620.414,555 635.261,623	9.562	8	620.414,555 635.261,623	9	620.410,223 635.261,388	4.339	9	620.410,223 635.261,388	10	620.407,834 635.261,28	2.391
10	620.407,834 635.261,28	11	620.383,859 635.266,514	24.53	11	620.383,859 635.266,514	12	620.370,977 635.272,678	14.28	12	620.370,977 635.272,678	13	620.349,103 635.301,909	36.51
13	620.349,103 635.301,909	14	620.338,394 635.321,129	22.00	14	620.338,394 635.321,129	15	620.327,834 635.345,806	26.84	15	620.327,834 635.345,806	16	620.303,652 635.400,066	59.40
16	620.303,652 635.400,066	17	620.284,296 635.447,159	50.91	17	620.284,296 635.447,159	18	620.260,285 635.482,001	42.31	18	620.260,285 635.482,001	19	620.234,294 635.516,087	42.86

Punct început	X / Y	Punct sfârșit	X / Y	Lungime segment	Punct început	X / Y	Punct sfârșit	X / Y	Lungime segment	Punct început	X / Y	Punct sfârșit	X / Y	Lungime segment
19	620.234,294 635.516,087	20	620.228,616 635.524,262	9.954	20	620.228,616 635.524,262	21	620.208,979 635.544,491	28.192	21	620.208,979 635.544,491	22	620.177,625 635.569,481	40.095
22	620.177,625 635.569,481	23	620.162,318 635.579,379	18.228	23	620.162,318 635.579,379	24	620.149,778 635.585,987	14.174	24	620.149,778 635.585,987	25	620.136,497 635.588,486	13.514
25	620.136,497 635.588,486	26	620.130,921 635.586,514	5.915	26	620.130,921 635.586,514	27	620.125,801 635.583,527	5.928	27	620.125,801 635.583,527	28	620.119,598 635.577,734	8.488
28	620.119,598 635.577,734	29	620.113,052 635.568,434	11.372	29	620.113,052 635.568,434	30	620.103,355 635.553,568	17.75	30	620.103,355 635.553,568	31	620.092,545 635.538,446	18.589
31	620.092,545 635.538,446	32	620.088,443 635.534,633	5.6	32	620.088,443 635.534,633	33	620.082,589 635.529,638	7.695	33	620.082,589 635.529,638	34	620.073,53 635.523,879	10.734
34	620.073,53 635.523,879	35	620.067,21 635.523,294	6.347	35	620.067,21 635.523,294	36	620.063,066 635.523,789	4.173	36	620.063,066 635.523,789	37	620.052,461 635.528,691	11.684
37	620.052,461 635.528,691	38	620.043,428 635.539,388	14.0	38	620.043,428 635.539,388	39	620.026,438 635.567,659	32.984	39	620.026,438 635.567,659	40	619.997,294 635.592,112	38.044
40	619.997,294 635.592,112	41	619.987,569 635.597,9	11.317	41	619.987,569 635.597,9	42	619.982,78 635.600,412	5.408	42	619.982,78 635.600,412	43	619.972,244 635.605,458	11.682
43	619.972,244 635.605,458	44	619.965,03 635.608,881	7.985	44	619.965,03 635.608,881	45	619.955,48 635.614,27	10.966	45	619.955,48 635.614,27	46	619.945,419 635.620,005	11.58
46	619.945,419 635.620,005	47	619.940,312 635.622,397	5.64	47	619.940,312 635.622,397	48	619.934,056 635.624,06	6.473	48	619.934,056 635.624,06	49	619.930,268 635.624,241	3.792
49	619.930,268 635.624,241	50	619.924,582 635.623,979	5.693	50	619.924,582 635.623,979	51	619.911,586 635.620,046	13.578	51	619.911,586 635.620,046	52	619.913,528 635.616,981	3.628
52	619.913,528 635.616,981	53	619.917,153 635.618,596	3.969	53	619.917,153 635.618,596	54	619.925,093 635.620,999	8.296	54	619.925,093 635.620,999	55	619.930,266 635.621,237	5.178
55	619.930,266 635.621,237	56	619.932,761 635.621,119	2.498	56	619.932,761 635.621,119	57	619.933,594 635.621,079	0.834	57	619.933,594 635.621,079	58	619.939,282 635.619,567	5.886
58	619.939,282 635.619,567	59	619.944,038 635.617,339	5.252	59	619.944,038 635.617,339	60	619.952,543 635.612,492	9.789	60	619.952,543 635.612,492	61	619.954,0 635.611,661	1.678
61	619.954,0 635.611,661	62	619.958,591 635.609,07	5.272	62	619.958,591 635.609,07	63	619.962,873 635.606,653	4.917	63	619.962,873 635.606,653	64	619.963,648 635.606,216	0.889
64	619.963,648 635.606,216	65	619.967,458 635.604,408	4.218	65	619.967,458 635.604,408	66	619.970,953 635.602,75	3.868	66	619.970,953 635.602,75	67	619.979,079 635.598,858	9.01
67	619.979,079 635.598,858	68	619.981,435 635.597,73	2.612	68	619.981,435 635.597,73	69	619.986,104 635.595,281	5.272	69	619.986,104 635.595,281	70	619.987,8 635.594,271	1.974
70	619.987,8 635.594,271	71	619.995,551 635.589,658	9.02	71	619.995,551 635.589,658	72	619.999,127 635.586,657	4.669	72	619.999,127 635.586,657	73	620.002,529 635.583,803	4.44
73	620.002,529 635.583,803	74	620.011,309 635.576,436	11.462	74	620.011,309 635.576,436	75	620.017,766 635.571,018	8.428	75	620.017,766 635.571,018	76	620.023,989 635.565,797	8.123
76	620.023,989 635.565,797	77	620.024,125 635.565,683	0.177	77	620.024,125 635.565,683	78	620.026,588 635.561,585	4.781	78	620.026,588 635.561,585	79	620.029,123 635.557,367	4.921
79	620.029,123 635.557,367	80	620.034,928 635.547,708	11.269	80	620.034,928 635.547,708	81	620.039,579 635.539,969	9.03	81	620.039,579 635.539,969	82	620.040,981 635.537,636	2.722
82	620.040,981 635.537,636	83	620.045,492 635.532,294	6.992	83	620.045,492 635.532,294	84	620.048,087 635.529,221	4.021	84	620.048,087 635.529,221	85	620.049,159 635.527,951	1.662
85	620.049,159 635.527,951	86	620.050,169 635.526,755	1.565	86	620.050,169 635.526,755	87	620.050,598 635.526,247	0.665	87	620.050,598 635.526,247	88	620.056,205 635.523,655	6.177
88	620.056,205 635.523,655	89	620.061,33 635.521,286	5.646	89	620.061,33 635.521,286	90	620.062,239 635.520,866	1.002	90	620.062,239 635.520,866	91	620.065,875 635.520,432	3.661
91	620.065,875 635.520,432	92	620.067,17 635.520,278	1.305	92	620.067,17 635.520,278	93	620.068,368 635.520,389	1.203	93	620.068,368 635.520,389	94	620.074,528 635.520,958	6.186
94	620.074,528 635.520,958	95	620.084,376 635.527,219	11.67	95	620.084,376 635.527,219	96	620.090,439 635.532,392	7.97	96	620.090,439 635.532,392	97	620.094,809 635.536,455	5.967
97	620.094,809 635.536,455	98	620.105,833 635.551,875	18.955	98	620.105,833 635.551,875	99	620.115,536 635.566,751	17.761	99	620.115,536 635.566,751	100	620.121,872 635.575,753	11.008
100	620.121,872 635.575,753	101	620.127,603 635.581,105	7.841	101	620.127,603 635.581,105	102	620.132,188 635.583,78	5.308	102	620.132,188 635.583,78	103	620.136,736 635.585,388	4.824
103	620.136,736 635.585,388	104	620.148,779 635.583,122	12.254	104	620.148,779 635.583,122	105	620.160,801 635.576,787	13.589	105	620.160,801 635.576,787	106	620.175,871 635.567,042	17.946
106	620.175,871 635.567,042	107	620.206,96 635.542,264	39.755	107	620.206,96 635.542,264	108	620.226,292 635.522,349	27.755	108	620.226,292 635.522,349	109	620.231,868 635.514,321	9.774
109	620.231,868 635.514,321	110	620.257,856 635.480,239	42.86	110	620.257,856 635.480,239	111	620.281,643 635.445,721	41.92	111	620.281,643 635.445,721	112	620.300,894 635.398,885	50.638
112	620.300,894 635.398,885	113	620.325,085 635.344,605	59.427	113	620.325,085 635.344,605	114	620.335,697 635.319,805	26.975	114	620.335,697 635.319,805	115	620.346,58 635.300,273	22.359
115	620.346,58 635.300,273	116	620.369,017 635.270,29	37.449	116	620.369,017 635.270,29	117	620.382,879 635.263,657	15.367	117	620.382,879 635.263,657	118	620.407,578 635.258,265	25.281

Punct început	X / Y	Punct sfârșit	X / Y	Lungime segment	Punct început	X / Y	Punct sfârșit	X / Y	Lungime segment	Punct început	X / Y	Punct sfârșit	X / Y	Lungime segment
118	620.407,578 635.258,265	119	620.410,372 635.258,392	2.797	119	620.410,372 635.258,392	120	620.414,379 635.258,609	4.013	120	620.414,379 635.258,609	121	620.422,98 635.257,124	8.728
121	620.422,98 635.257,124	122	620.427,369 635.254,738	4.996	122	620.427,369 635.254,738	123	620.458,429 635.222,32	44.896	123	620.458,429 635.222,32	124	620.495,984 635.185,878	52.33
124	620.495,984 635.185,878	125	620.543,249 635.148,357	60.347	125	620.543,249 635.148,357	126	620.560,336 635.136,289	20.919	126	620.560,336 635.136,289	127	620.648,319 635.093,971	97.631
127	620.648,319 635.093,971	128	620.664,152 635.085,299	18.052	128	620.664,152 635.085,299	129	620.694,547 635.058,476	40.538	129	620.694,547 635.058,476	130	620.703,095 635.051,129	11.272
130	620.703,095 635.051,129	131	620.713,763 635.042,12	13.963	131	620.713,763 635.042,12	132	620.728,12 635.026,638	21.114	132	620.728,12 635.026,638	133	620.739,781 635.007,696	22.244
133	620.739,781 635.007,696	134	620.792,951 634.938,416	87.331	134	620.792,951 634.938,416	135	620.829,554 634.897,452	54.935	135	620.829,554 634.897,452	136	620.850,349 634.865,954	37.743
136	620.850,349 634.865,954	137	620.867,238 634.849,04	23.902	137	620.867,238 634.849,04	138	620.884,778 634.838,714	20.354	138	620.884,778 634.838,714	139	620.905,729 634.816,497	30.538
139	620.905,729 634.816,497	140	620.922,372 634.802,337	21.852	140	620.922,372 634.802,337	141	620.927,292 634.796,406	7.706	141	620.927,292 634.796,406	142	620.949,376 634.777,217	29.256
142	620.949,376 634.777,217	143	620.970,049 634.769,423	22.094	143	620.970,049 634.769,423	144	620.972,924 634.771,545	3.573	144	620.972,924 634.771,545	145	620.950,938 634.779,835	23.497
145	620.950,938 634.779,835	146	620.929,445 634.798,51	28.473	146	620.929,445 634.798,51	147	620.924,515 634.804,453	7.721	147	620.924,515 634.804,453	148	620.907,799 634.818,675	21.947
148	620.907,799 634.818,675	149	620.886,668 634.841,083	30.8	149	620.886,668 634.841,083	150	620.869,088 634.851,432	20.4	150	620.869,088 634.851,432	151	620.852,777 634.867,722	23.053
151	620.852,777 634.867,722	152	620.831,937 634.899,288	37.824	152	620.831,937 634.899,288	153	620.795,263 634.940,331	55.042	153	620.795,263 634.940,331	154	620.742,255 635.009,4	87.065
154	620.742,255 635.009,4	155	620.730,52 635.028,462	22.384	155	620.730,52 635.028,462	156	620.715,838 635.044,294	21.592	156	620.715,838 635.044,294	157	620.705,041 635.053,413	14.133
157	620.705,041 635.053,413	158	620.696,517 635.060,738	11.239	158	620.696,517 635.060,738	159	620.665,886 635.087,77	40.853	159	620.665,886 635.087,77	1	620.649,691 635.096,64	18.466

** Lungimile segmentelor sunt determinate în planul de proiecție Stereo 70 și sunt rotunjite la 1 milimetru.

*** Distanța dintre puncte este formată din segmente cumulate ce sunt mai mici decât valoarea 1 milimetru.